

NOTE: BREAK ALL CORNERS WITH 0.015" (.38 MM) RADIUS UNLESS OTHERWISE NOTED. STANDARD TOLERANCES TO APPLY UNLESS OTHERWISE SPECIFIED.

CUSTOMER PART No.	CUSTOMER	CAN ART OPEN	DIE No.
			ES07625
DESCRIPTION		INTERLOCK	PROPOSAL No.
			S-3107

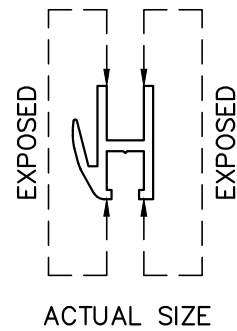
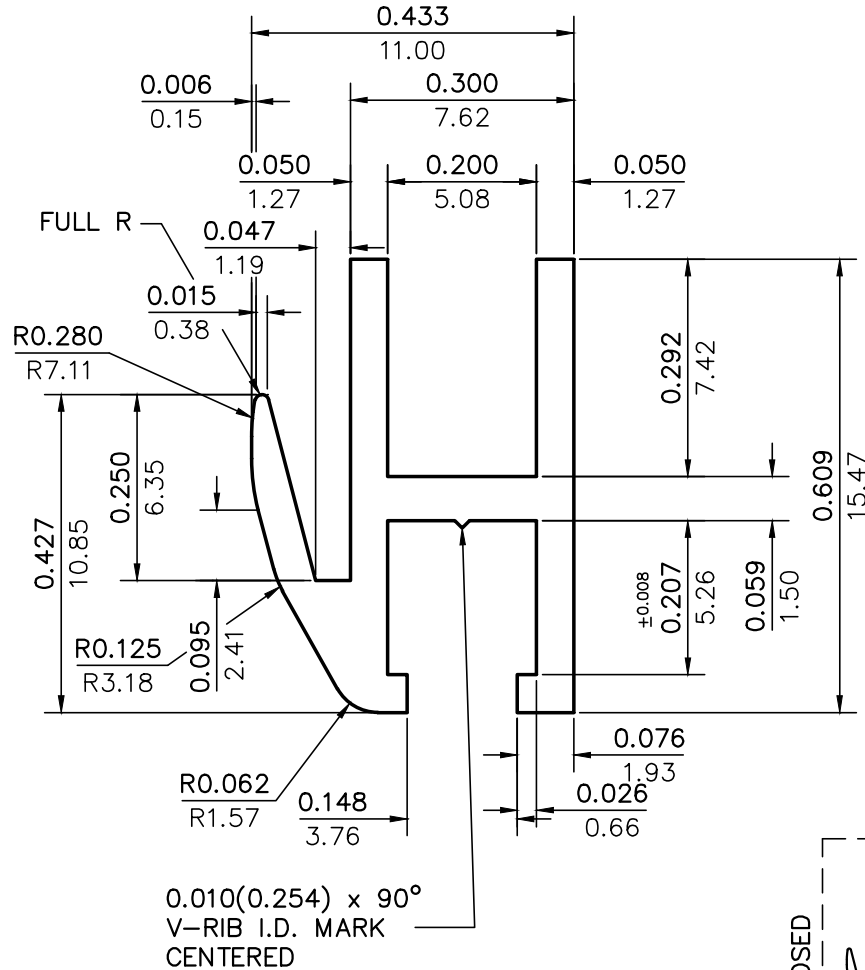

WALL THICKNESS 0.050 (1.27) EXCEPT AS SHOWN

DATE	REV	DESCRIPTION	BY
05/31/99	1	REDRAWN	P.M.
11/14/00	2	UPDATED DRAWING	P.M.
EST.AREA	0.095	IN. ²	EST.AREA 61.308
			MM. ²
EST.WT.	0.112	LBS/FT.	EST.WT. 0.167
			KG/M.
EST.PER.	3.619	IN.	EST.PER. 91.920
			MM.
OUT PER.		IN.	OUT PER.
			MM.
C.C.D.	0.679	IN.	C.C.D. 17.245
			MM.
FACTOR	32	FINISH	PAINT
		ALLOY & TEMP.	6063-T5
CKD BY	SCALE	DWN BY	DATE
	4:1	C.P.	07/09/93

CAN ART

ALUMINUM EXTRUSION INC.

85 PARKSHORE DRIVE
BRAMPTON, ONT L6T 5M1
TEL. NO. (905) 791-1464
FAX NO. (905) 791-9151
E-MAIL: canart@canart.com

THIS DRAWING IS NOT NECESSARILY A COPY OF YOUR ORIGINAL. PLEASE APPROVE DIMENSIONS AND TOLERANCES INDICATED. CAN ART ASSUMES NO RESPONSIBILITY EITHER TECHNICAL OR LEGAL FOR HAVING THIS SHAPE MADE. THE CUSTOMER AGREES TO FULLY PROTECT CAN ART ALUMINUM FROM CLAIMS OF OTHERS RESULTING FROM THIS SHAPE.

SIGNED: _____ DATE: _____