

CUSTOMER PART No.

CUSTOMER

CAN ART OPEN

DIE No.

ES60743

DESCRIPTION

F

PROPOSAL No.

S-51561

NOTE: BREAK ALL CORNERS WITH 0.015" (.38 MM) RADIUS UNLESS OTHERWISE NOTED. STANDARD TOLERANCES TO APPLY UNLESS OTHERWISE SPECIFIED.

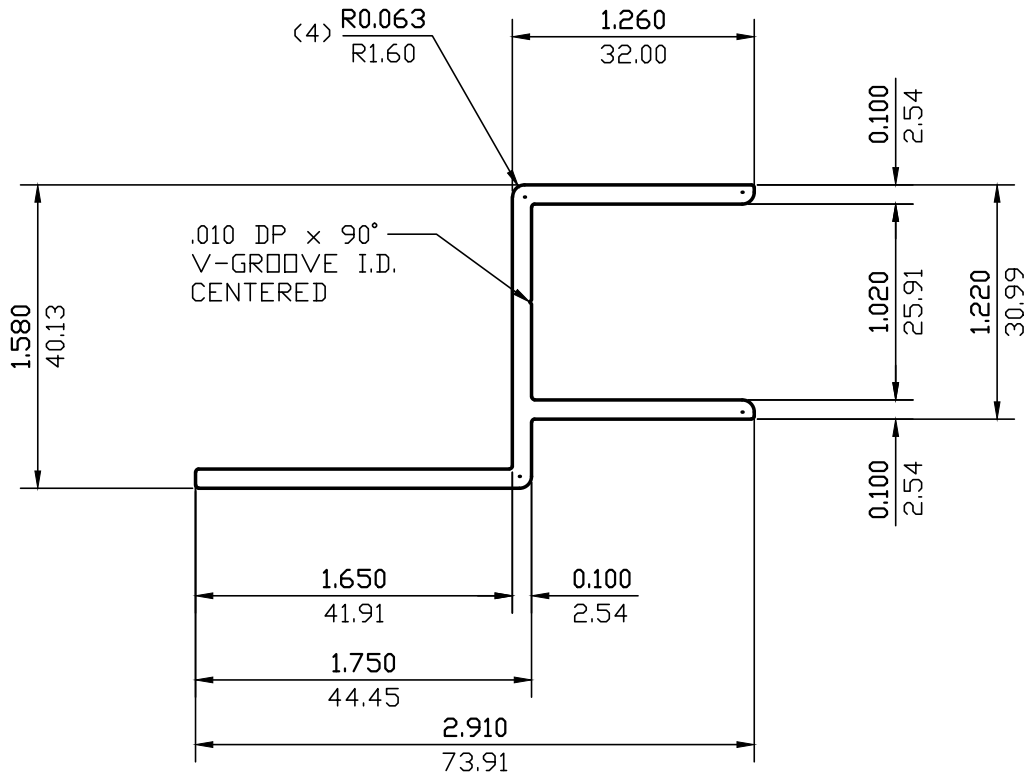

EXPOSED

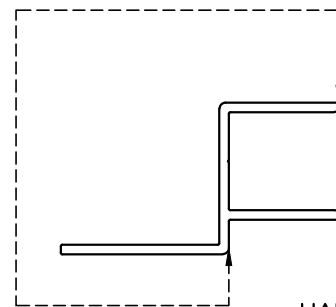

HALF SIZE

WALL THICKNESS 0.100(2.54) EXCEPT AS SHOWN

DATE	REV	DESCRIPTION	BY	
EST.AREA	0.551	IN. ²	EST.AREA 355.804	MM. ²
EST.WT.	0.662	LBS./FT.	EST.WT. 0.985	KG/M.
EST.PER.	11.149	IN.	EST.PER. 283.175	MM.
OUT PER.		IN.	OUT PER.	MM.
C.C.D.	3.297	IN.	C.C.D. 83.745	MM.
FACTOR 17	FINISH M/F	ALLOY & TEMP. 6063		
CKD BY	SCALE 1:1	DWN BY L.G.	DATE 05/30/2003	

CAN ART

ALUMINUM EXTRUSION INC.

428 JUTRAS DRIVE S.
WINDSOR, ONT. N8N 5C5
TEL. NO. (519) 727-4399
FAX NO. (519) 727-6434
E-MAIL: canart@canart.com

THIS DRAWING IS NOT NECESSARILY A COPY OF YOUR ORIGINAL. PLEASE APPROVE DIMENSIONS AND TOLERANCES INDICATED. CAN ART ASSUMES NO RESPONSIBILITY EITHER TECHNICAL OR LEGAL FOR HAVING THIS SHAPE MADE. THE CUSTOMER AGREES TO FULLY PROTECT CAN ART ALUMINUM FROM CLAIMS OF OTHERS RESULTING FROM THIS SHAPE.

SIGNED: _____ DATE: _____