

CUSTOMER PART No.

CUSTOMER

# CAN ART OPEN

DIE No.

EH11066

DESCRIPTION

3/4" x 3/4" x 0.120" SQUARE TUBE

PROPOSAL No.

H-9834

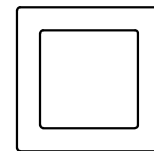
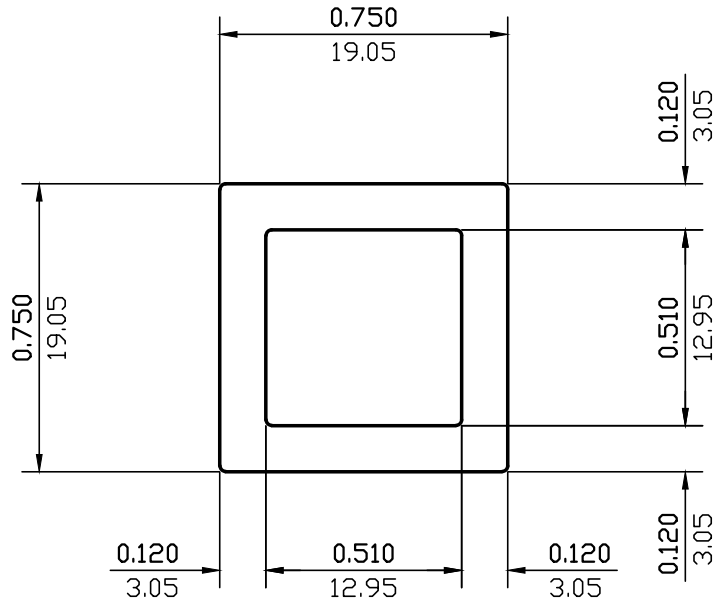

ACTUAL SIZE

NOTE: BREAK ALL CORNERS WITH 0.015" (.38 MM) RADIUS UNLESS OTHERWISE NOTED. STANDARD TOLERANCES TO APPLY UNLESS OTHERWISE SPECIFIED.

WALL THICKNESS 0.120 (3.05) EXCEPT AS SHOWN

DATE	REV	DESCRIPTION	BY
EST.AREA	0.302	IN. <sup>2</sup>	EST.AREA 195
EST.WT.	0.363	LBS./FT.	EST.WT. 0.540
EST.PER.	4.988	IN.	EST.PER. 126.7
OUT PER.	2.974	IN.	OUT PER. 75.5
C.C.D.	1.048	IN.	C.C.D. 27
FACTOR	14	FINISH	M/F
		ALLOY & TEMP.	6063
CKD BY	SCALE	2:1	DWN BY P.M. DATE 06/10/00

## CAN ART

ALUMINUM EXTRUSION INC.

85 PARKSHORE DRIVE  
BRAMPTON, ONT L6T 5M1  
TEL. NO. (905) 791-1464  
FAX NO. (905) 791-9151  
E-MAIL: canart@canart.com

THIS DRAWING IS NOT NECESSARILY A COPY OF YOUR ORIGINAL. PLEASE APPROVE DIMENSIONS AND TOLERANCES INDICATED. CAN ART ASSUMES NO RESPONSIBILITY EITHER TECHNICAL OR LEGAL FOR HAVING THIS SHAPE MADE. THE CUSTOMER AGREES TO FULLY PROTECT CAN ART ALUMINUM FROM CLAIMS OF OTHERS RESULTING FROM THIS SHAPE.

SIGNED: \_\_\_\_\_ DATE: \_\_\_\_\_