

CUSTOMER PART No.

CUSTOMER

CAN ART OPEN

DIE No.

ES05100

DESCRIPTION

EX-1

PROPOSAL No.

S-351

NOTE: BREAK ALL CORNERS WITH 0.015" (.38 MM) RADIUS UNLESS OTHERWISE NOTED. STANDARD TOLERANCES TO APPLY UNLESS OTHERWISE SPECIFIED.

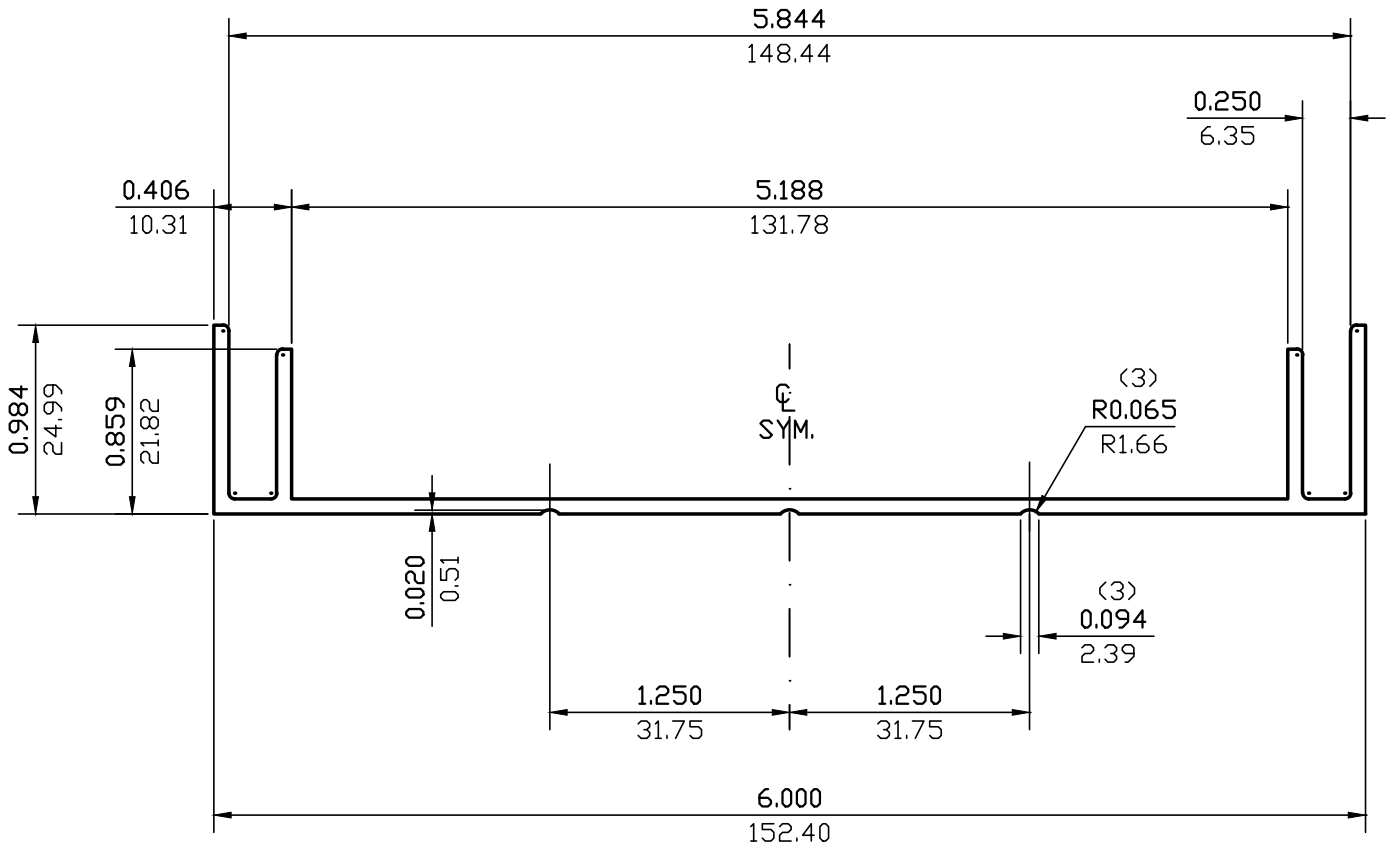

NOTE:

(·) = R0.031 (R0.79) (8)

WALL THICKNESS 0.078 (1.98) EXCEPT AS SHOWN

| DATE | REV | DESCRIPTION | BY |
|----------|--------|------------------|---------------------------|
| | | | |
| | | | |
| EST.AREA | 0.727 | IN. ² | EST.AREA 469 |
| EST.WT. | 0.858 | LBS./FT. | EST.WT. 1.277 |
| EST.PER. | 18.830 | IN. | EST.PER. 478.3 |
| OUT PER. | | IN. | OUT PER. |
| C.C.D. | 6.080 | IN. | C.C.D. 154 |
| FACTOR | 22 | FINISH | ALLOY & TEMP. 6063 |
| CKD BY | | SCALE 1:1 | DWN BY G.M. DATE 01/25/88 |

CAN ART

ALUMINUM EXTRUSION INC.

85 PARKSHORE DRIVE
BRAMPTON, ONT L6T 5M1
TEL. NO. (905) 791-1464
FAX NO. (905) 791-9151
E-MAIL: canart@canart.com

THIS DRAWING IS NOT NECESSARILY A COPY OF YOUR ORIGINAL. PLEASE APPROVE DIMENSIONS AND TOLERANCES INDICATED. CAN ART ASSUMES NO RESPONSIBILITY EITHER TECHNICAL OR LEGAL FOR HAVING THIS SHAPE MADE. THE CUSTOMER AGREES TO FULLY PROTECT CAN ART ALUMINUM FROM CLAIMS OF OTHERS RESULTING FROM THIS SHAPE.

SIGNED: _____ DATE: _____